



51 Waveney Valley Holiday Village Butt Lane

, Burgh Castle, NR31 9FN

£40,000



## 51 Waveney Valley

, Burgh Castle, NR31 9FN

**\*\*\*Chain Free\*\*\*** A fantastic opportunity to acquire this well-presented 2 bedroom mid-terrace holiday chalet, situated in a peaceful setting with communal grounds perfect for relaxing or socializing.

Offered on a Freehold basis, this property is ideal as a holiday retreat or investment opportunity. The chalet benefits from LPG gas connection and is UPVC double glazed throughout, ensuring warmth and efficiency.

### Lounge

12'9" x 10'2" (3.9m x 3.1m)

Laminate floor, access to 2 bedrooms, bathroom, kitchen, radiator, double glazed window and door to front.

### Kitchen

4'11" x 6'2" (1.5m x 1.9m)

Vinyl floor, radiator, double glazed window to rear, laminate countertops, under counter and wall mounted cupboards, free standing oven with extractor fan, sink and draining board, space for under counter fridge.

### Bedroom 1

7'10" x 8'2" (2.4 x 2.5m)

Laminate floor, built in cupboards, double glazed windows to rear, radiator.

### Bedroom 2

7'10" x 7'10" (2.4m x 2.4)

Laminate floor, double glazed windows to front, radiator.

### Bathroom

Vinyl floor, WC, basin, bath, double glazed window to rear, built in storage.

### Tenure

Freehold - 1st March-14th January annually - The vendor informs us that the site charge is approx. £1,500 a year

### Services

Mains electric, water, drainage, LPG gas.





### Council Tax

Great Yarmouth Borough Council - Band A

### Location

Burgh Castle is a semi rural village 2 miles west of Gorleston and 4 miles from Great Yarmouth \* The River Waveney and Breydon Water are on the outskirts of the village giving access to the Norfolk and Suffolk Broads \* There is a yacht marina and historic Roman Castle ruins.

### Directions

Leave Gorleston on the A143 Beccles Road, continue through Bradwell, turn right at the roundabout into New Road, continue into Belton, at the mini roundabout turn right into Stepshort, continue into Burgh Castle, continue into Butt Lane. Turn left into Waveney Valley Holiday Village at the Kingfisher Park Homes site.

### What3Words

///stables.prevented.bicker

### Ref

G18316/05/25



## Floor Plan

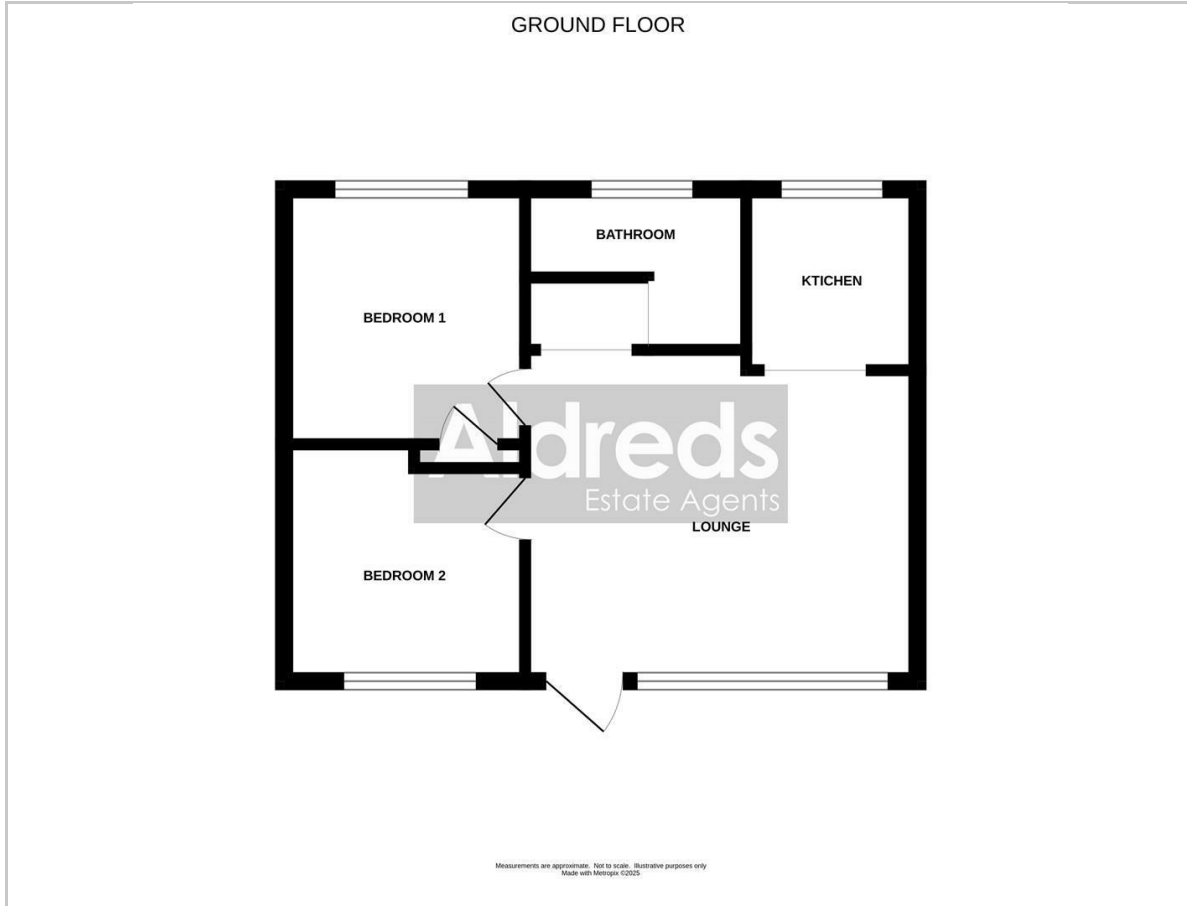

## Viewing

Please contact our Aldreds Gorleston Office on 01493 664600 if you wish to arrange a viewing appointment for this property or require further information.

### Disclaimer

These particulars are issued on an understanding that all negotiations shall be conducted through Messrs. Aldreds. Please note: Messrs. Aldreds for themselves and for the vendors or lessors of this property whose agents they are given notice that: 1. Particulars are set out as a general outline only for guidance of intending purchasers or lessees, and do not constitute nor constitute part of, an offer or contract. 2. All descriptions, dimensions, references to condition and necessary permissions for use and occupation, and other details are given without responsibility and any intending purchasers or tenants should not rely on them as statements or representations of fact but must satisfy themselves by inspection or otherwise as to the correctness of each of them. 3. No person in the employment of Messrs. Aldreds has any authority to make or give any representation or warranty whatever in relation to this property. 4. If you are proposing to visit the property and are travelling some distance please check with Aldreds on the issue of availability prior to travelling. 5. Aldreds Property Consultants and associated services may offer additional services to the prospective purchaser for which they will be entitled to receive a commission.

Aldreds are pleased to be working with Mortgage Advice Bureau. They're an award-winning mortgage broker with over 1,400 advisers across the UK, and have access to over 12,000 mortgage products from over 90 lenders. Aldreds Estate Agents Ltd receive a commission of £200 on each completed case. Your home may be repossessed if you do not keep up repayments on your mortgage. There may be a fee for mortgage advice. The actual amount you pay will depend upon your circumstances. The fee is up to 1%, but a typical fee is 0.3% of the amount borrowed. Mortgage Advice Bureau is a trading name of Mortgage Seeker Limited which is an appointed representative of Mortgage Advice Bureau Limited and Mortgage Advice Bureau (Derby) Limited which are authorised and regulated by the Financial Conduct Authority. Mortgage Seeker Limited Registered Office: Lovewell Blake, Sixty Six North Quay, Great Yarmouth, Norfolk, NR30 1HE. Registered in England Number: 03721415. 6. Potential purchasers should check with their providers that the broadband and mobile phone coverage they would require is available.

## Area Map



## Energy Efficiency Graph

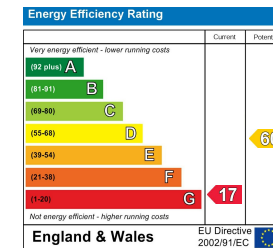

149 High Street, Gorleston, Norfolk, NR31 6RB  
Tel: 01493 664600 Email: [gorleston@aldreds.co.uk](mailto:gorleston@aldreds.co.uk) <https://www.aldreds.co.uk/>

Registered in England Reg. No. 08945751 Registered Office: 66 North Quay, Great Yarmouth, Norfolk NR30 1HE Directors: Mark Duffield B.S.c. FRICS. Dan Crawley MNAEA Paul Lambert MNAEA